

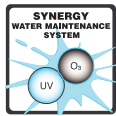

**Swim Spa  
World**

# THE FLORIDA 4

PASSION SPAS EXCLUSIVE COLLECTION



## SPECIFICATIONS/GENERAL

Dimensions L x W x H.....	305 x 228 x 91 cm
Number of Seats.....	5
Number of Loungers.....	2
Capacity in Liter.....	1650
Dry Weight in kg.....	500
Full Weight in kg.....	2150
Shell Material.....	Aristech® Acrylic with Vinylester and Polyester
Synthetic Maintenance Free Cabinet.....	Standard
Removable Side Panels.....	4
Durable Support System.....	Synthetic
Everlast™ Full Floor Support Material.....	Polyester
High Density Urethane Insulation.....	Standard
Cup Holders.....	6

## WATER SYSTEM

Total jets.....	150
Water Jets, Stainless Steel.....	134
Air Injector Jets.....	16
Air Control Valve.....	4
Filters/Surface.....	(1) 50 Square Feet
Top Access Skim Filter.....	High-Volume Vortex Skimmer
Floor Drain.....	1
External Drain.....	1
Hi Flow Suctions.....	4
Water Diverter Valve.....	2
6" Aqua Rolling Jet.....	1
5" Massage Jets, Directional, Rotational and Pulsational.....	7
3" Directional Jets.....	10
2" Directional Jets.....	14
Ozone Jets.....	2

## SPECIAL FEATURES

Soft Air Massage System.....	Standard
Aqua Rolling Massage.....	Standard
Intense Therapy Zone Massage.....	Standard
Therapy Wave Zone Massage.....	Standard
Levitation Bed.....	Standard
Molded Headrest Soft Pillows with LED Light.....	6
StarBrite Interior LED Light System.....	Standard
Waterfall Massage.....	Standard
Exterior Corner LED Lighting.....	2
Aromatherapy System.....	Standard
Ozone Sanitation System.....	Standard
UV Synergy System.....	Standard
Ultra Efficient Dual-Wrap Cabinet Insulation.....	Standard
5/4 Ultra Efficient Walk-On Cover.....	Optional
Wifi Ready.....	Standard

## PUMP INFORMATION

Massage Pump 1: LX LP300.....	2,2 kW
Massage Pump 2: LX LP300.....	2,2 kW
Massage Pump 3: LX LP300.....	2,2 kW
Filtration Pump: LX WTC50M.....	250 W
Air Pump: LX AP300.....	300 W
Wave Pump.....	300 W

## ELECTRICAL SYSTEM

Voltage.....	230/380 V
Amperage.....	32 Amp - 230V / 16 Amp - 380 V
Full Flow Electric Heater.....	3 kW
Control System.....	Balboa 6031XZ
Light (18 x Multi Color LED).....	Standard
Electronic Topside Control.....	Balboa TP800



**Swim Spa  
World**

# THE FLORIDA 4

PASSION SPAS EXCLUSIVE COLLECTION

**POWER SUPPLY**  
1x 16A/380V

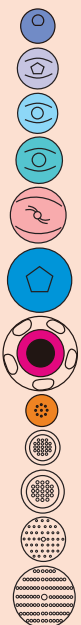
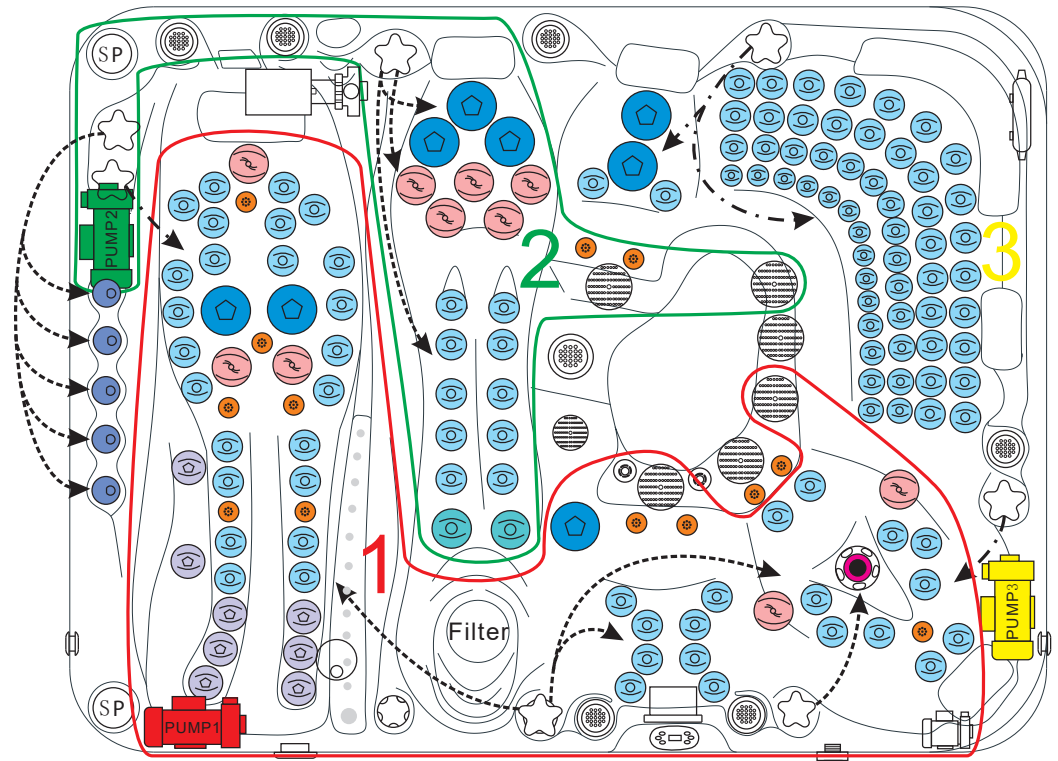

- Waterjet 153950 5pcs
- Clusterjet 150293 8pcs
- Clusterjet 151322 110pcs
- Clusterjet 152186 2pcs
- Mini Jet 150126 10pcs
- Power Jet 150155 8pcs
- Swim Jet 150202 1pc
- Blowerjet 150561 13pcs
- Spa Light 150766 6pcs
- Spa Light 150781 1pc
- Suction 150516 1pc
- Suction 150517 6pcs

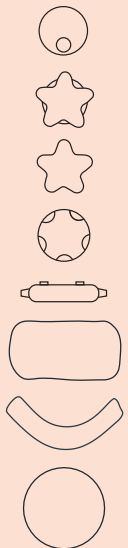

- Air Control 150827
- Water Diverter 150493
- Water/Air Control 150520
- Aromatherapy 150560
- UV lamp 150777
- Pillow 150403
- Corner Pillow 150387
- Filter lid Black 159111
- Filter 4ch-949 151131



Speaker 150321



Controller & Heater 152222  
JZ6013x2



Drainage 150511



WTC50 Circ. Pump 150817

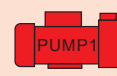

LP300 Mass. Pump 150818  
(3pcs)



TP800 Display 151061

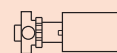

Diverter Pump 150828